

# WSB9(LE)

## Series Mini (Earth Leakage) Circuit Breaker

WSB9 circuit breaker has functions: protection to short circuit, overload, controlling, isolating.

WSB9 circuit breaker applies for LV terminal distribution of industrial & civil construction, energy & infrastructure field.

WSB9LE earth leakage circuit breaker has functions: protection to short circuit, overload and earth leakage, controlling, isolating.

WSB9LE earth leakage circuit breaker applies for LV terminal distribution of industrial & civil construction, energy & infrastructure field.

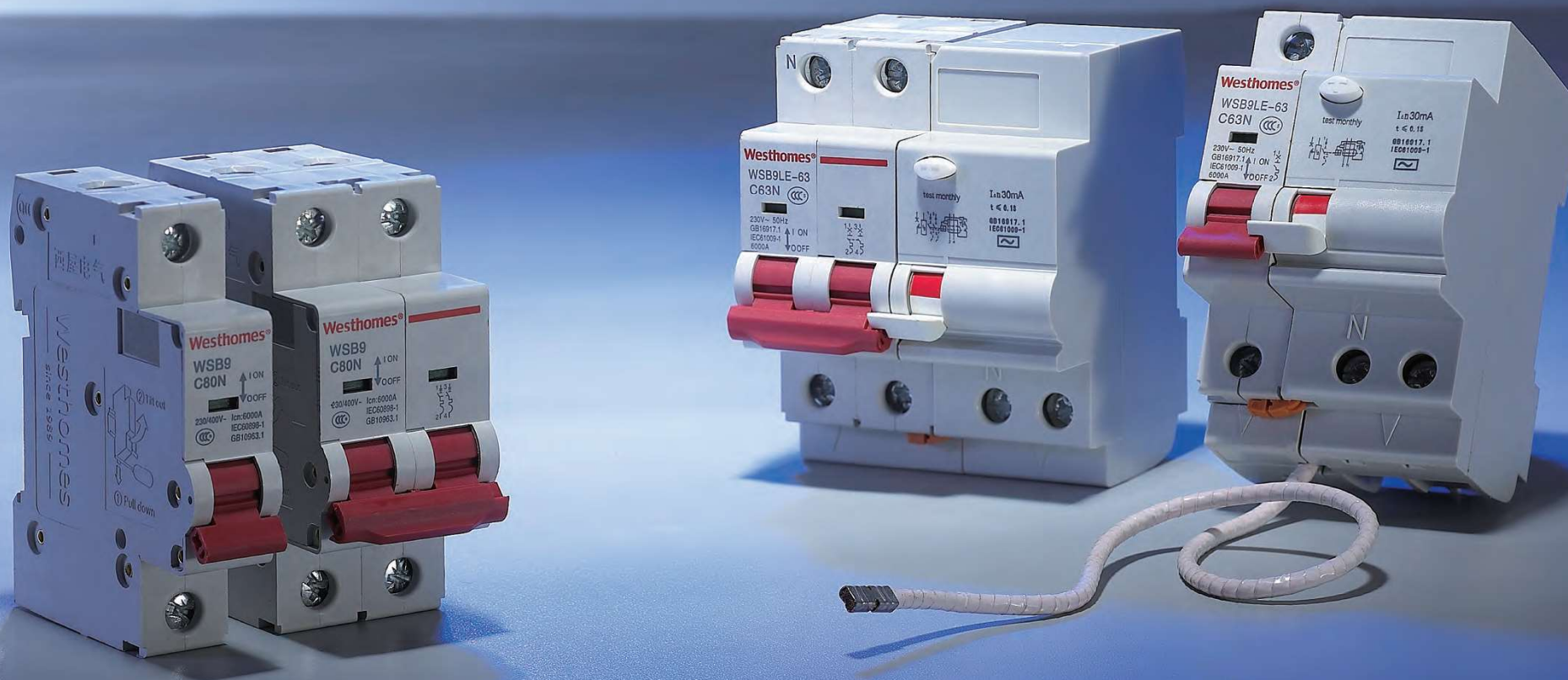

WSB9-63 1P



WSB9-63 3P

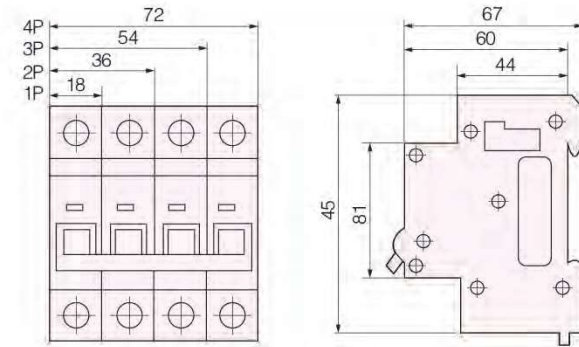

### Main technical parameters

Model	Rated current(A)	Pole(P)	Rated voltage(V)	Breaking capacity(A)	Type of instantaneous release	Current range of instantaneous protection
WSB9-63	6、10、16 20、25、32 40、50、63	1P,2P,3P,4P	230/400	N : 6.0kA(6~63A) H : 10kA(6~63A)	B	$3I_n < I \leq 5I_n$
					C	$5I_n < I \leq 10I_n$
					D	$10I_n < I \leq 50I_n$

Model	Type of release	Rated current of release In(A)	Starting state	Test current	Regulate time	Expected result	Remarks
WSB9-63	B、C、D	All value	cold state≤63A	1.13In	t≥1h	trip	current rise to the regulated value steadily in 5s
			cold state > 63A		t≥2h		
	B、C、D	All value	thermal≤63A	1.45In	t<1h	trip	
			thermal > 63A		t<2h		
	B、C、D	≤32	cold state	2.25In	1s<t<60s	trip	
		>32			1s<t<120s		
	B	All value	cold state	3In	t≥0.1s	no trip	close auxiliary switch, current on
	C			5In			
	D			10In			
	B	All value	cold state	5In	t<0.1s	trip	close auxiliary switch, current on
	C			10In			
	D			50In			